

Progressive Bath System Separate Plate

two rooms.

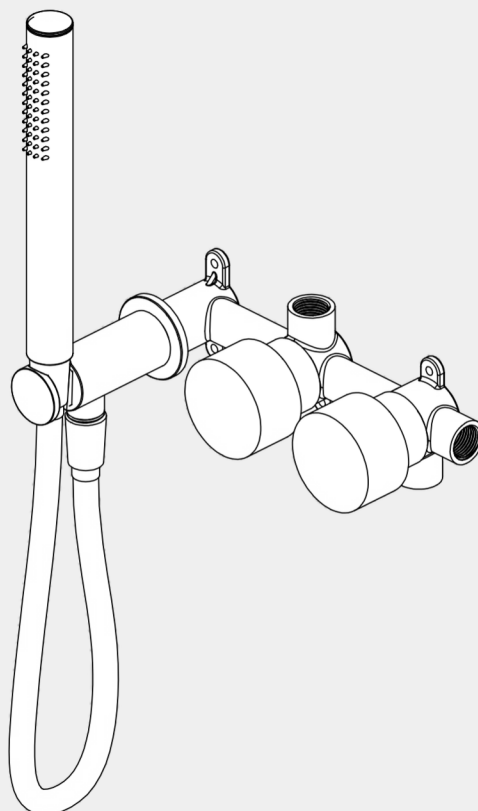

Versions:202401



Drawing

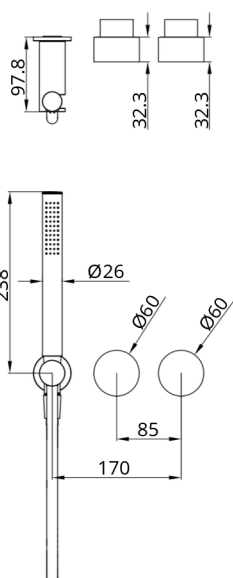

Specifications

Watermark License
WM-060073







Temperature Rating
Min 1 °C - Max 75 °C

Pressure Rating
Min 150kpa - Max 500kpa

Group Item

1x Universal Body
1x Trim Kits Only

Finish & SKU

 Chrome TR271903dCH	 Gun Metal TR271903dGM	 Brushed Bronze TR271903dBZ
 Matte Black TR271903dMB	 Brushed Gold TR271903dBG	 Brushed Nickel TR271903dBN

*Dimensions are nominal measurements only.

Installation Instruction For Bath System Body Only

Installation Depth 51-66mm

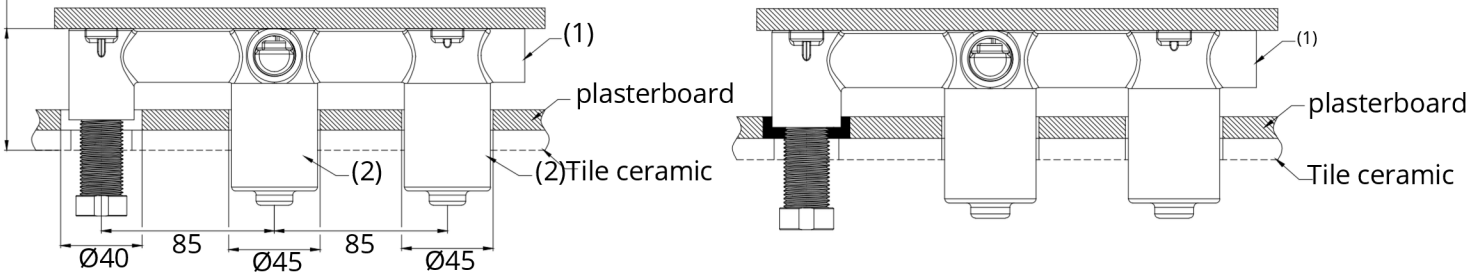

1. Fit off in-wall mixer body into wall structure, and ensure the installation depth is 51-66mm from the tile surface.
2. Connect hot, cold water lines. Test and check for leaks.
3. Install the plasterboard and make holes with diameters of $\text{Ø}40$, $\text{Ø}45$, $\text{Ø}40$, and $\text{Ø}45$.
4. Apply waterproofing between the plasterboard and the mixer body (1) to prevent any potential leaks.
5. The in-wall mixer body installation is complete. Check for leaks.

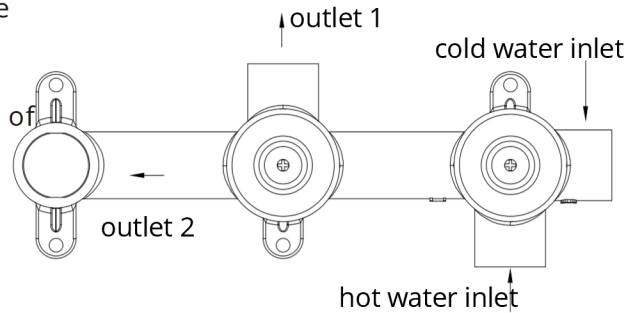

Installation Instruction For Bath System Trim Kits Only

Installation Depth 51-66mm

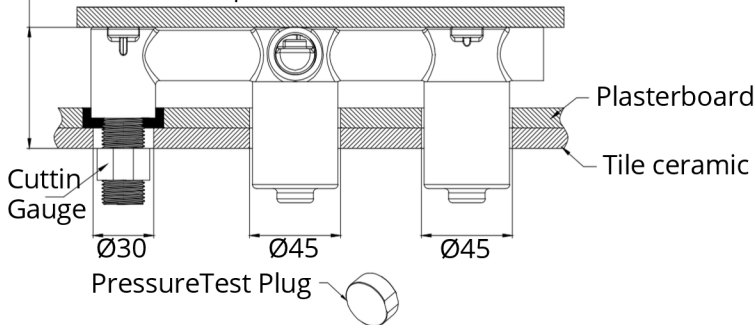

1. Install tiles and drill holes with diameters of $\text{Ø}30$, $\text{Ø}45$, $\text{Ø}45$.
2. Remove the pressure test plug.
3. Assemble the cutting gauge onto the mixer body, make it flush with the tile surface, and trim off any excess part after assembly.

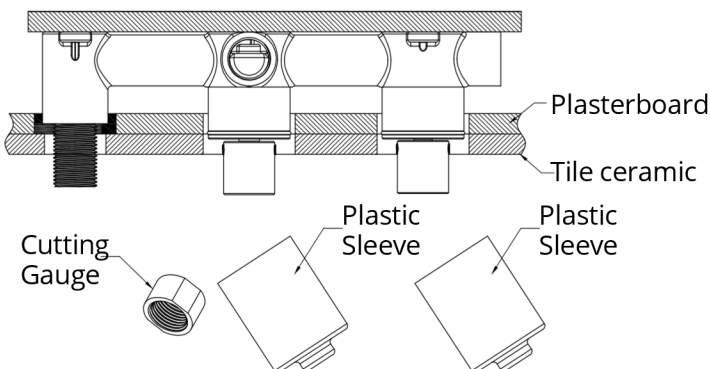

4. Remove the cutting gauge and protective sleeves.

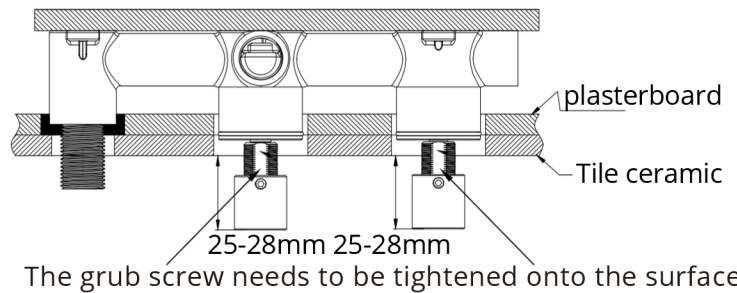

The grub screw needs to be tightened onto the surface.

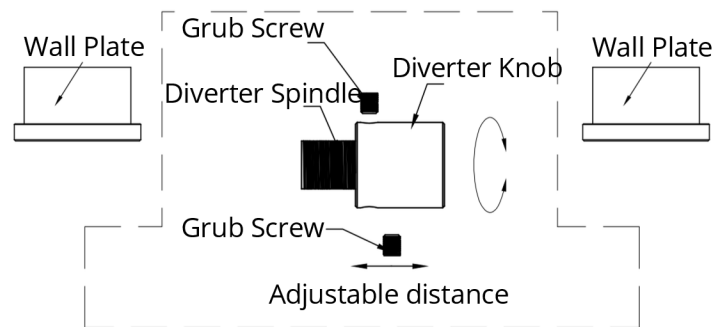

5. Adjust the distance between the Diverter knob and the tile surface to 25-28mm as shown in the diagram.
6. Place the wall plate onto the mixer body.

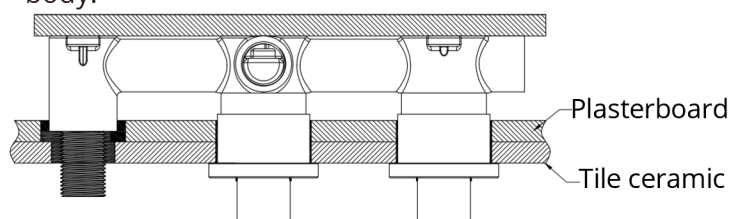

7. Apply waterproofing in the gap between the ceramic tile and the water outlet.

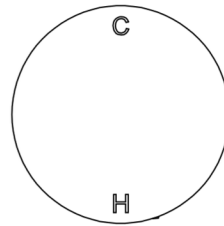
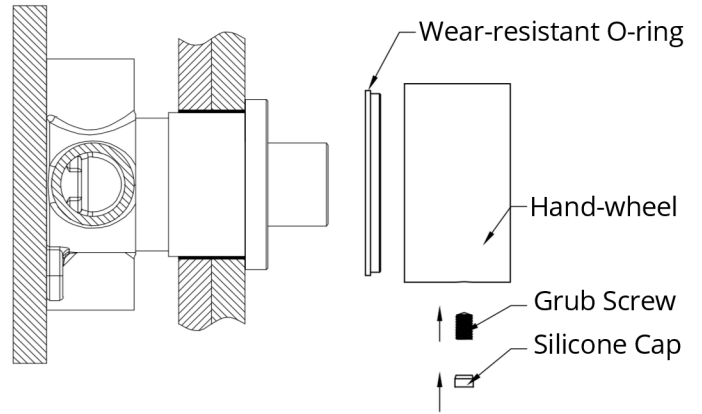
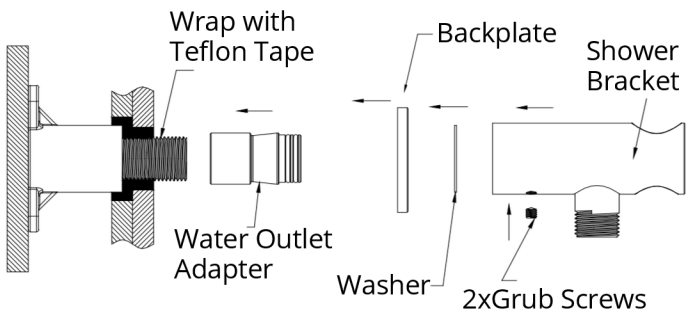

Hand-wheel

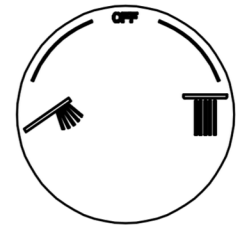

Diverter Knob

8. Thread the water outlet adapter onto the in-wall body, and seal with Teflon tape.
 9. Assemble the Backplate, washer, and shower bracket onto the main body, then secure with screws.

Follow step 10 to install the Hand-wheel and the Diverter Knob
 10. Attach the wear-resistant O-ring, hand-wheel/ Diverter knob, grub screw, and silicone cap, securing them in place.

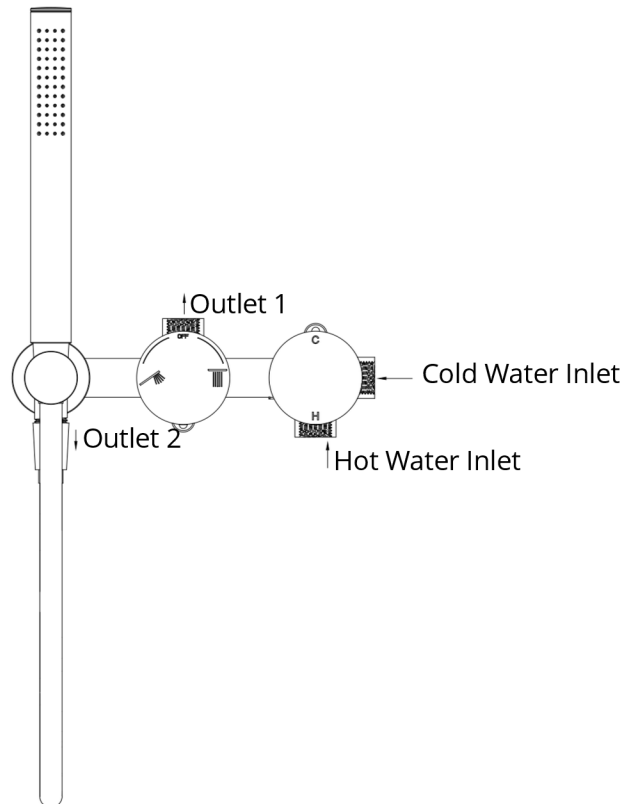
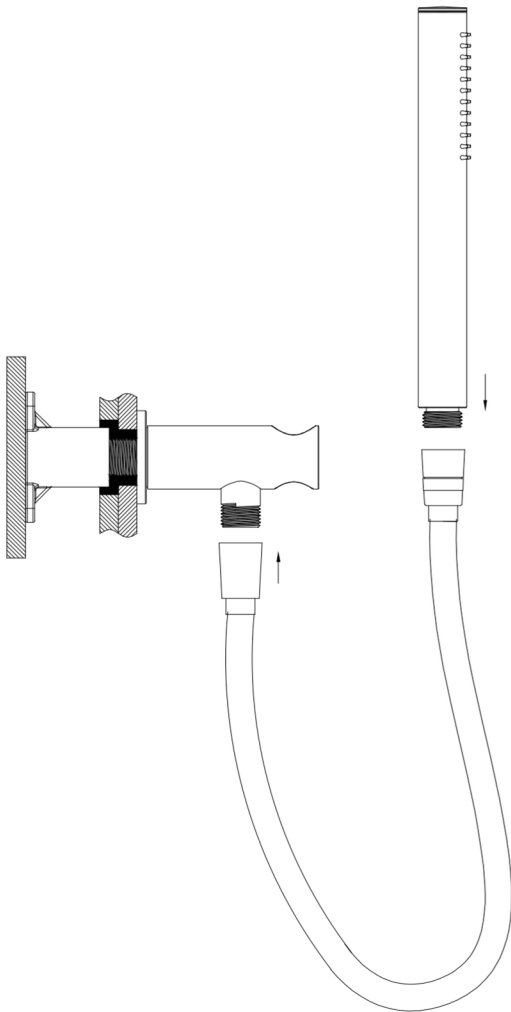

11. Attach the shower hose and hand shower, securing them in place.

12. Installation is now complete. Test for leaks.